

Perma-Fit® Divided Light Interior Grilles

for Andersen® 400/200 Series Casement & Awning, 400 Series Tilt-Wash & 200 Series Narroline® Double-Hung, and 400/200 Series Circle Top™ Windows



INSTALLER: Please leave this guide with the building owner to file for future reference.

For ease of installation and continued enjoyment of your Andersen® product, please read and follow this Instruction Guide completely. You may direct any questions about this or other products to your local Andersen dealer, found in the Yellow Pages under “Windows”, or call Andersen WindowCare® service center at 1-888-888-7020 Monday through Friday, 7 a.m. to 7 p.m. Central Time and Saturday, 8 a.m. to 4 p.m. Central Time. Assembly and installation of Andersen products is the sole responsibility of the architect, building owner, contractor and/or consumer and Andersen has no responsibility in this regard. Thank you for choosing Andersen.

⚠ WARNING

Use of ladders and/or scaffolding and working at elevated levels may be hazardous. Follow equipment manufacturer's instructions for safe operation. Use extreme caution when working around window and door openings. Falling from opening may result in personal injury or death.

⚠ WARNING

Improper use of hand or power tools could result in personal injury and/or product damage. Follow equipment manufacturer's instructions for safe operation. Always wear safety glasses.

⚠ WARNING

Weight of window and door unit(s) and accessories will vary. Use a reasonable number of people with sufficient strength to lift, carry, and install window and door unit(s) and accessories. Always use appropriate lifting techniques.

1. Prepare Sash

- For Casement and Awning Units, sash edges are notched at the factory to receive *Grille Tips*.
- For Double-Hung and Circle Top Units, drill or punch out center of all plastic grommets located around *Sash*. Use a 1/8” drill bit or large size nail set tool.

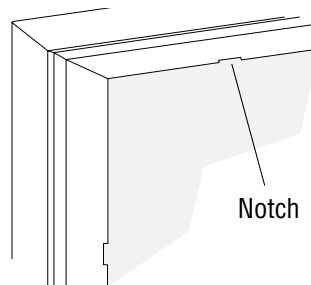

Casement or Awning

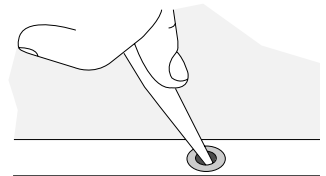

Double-Hung or Circle Top

2. Install Grille

Casement, Awning, and Double-Hung Units

- Position *Grille Tips* into grommets (Double-Hung) or notches (Casement/Awning) in bottom rail of *Sash*.

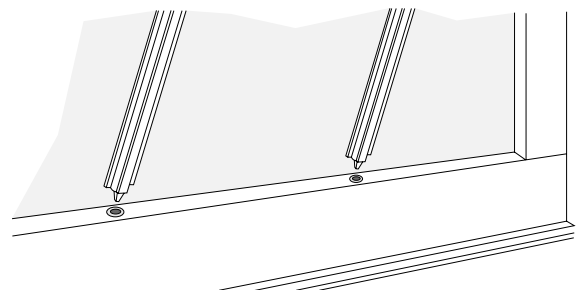

Casement, Awning, and Double-Hung Units

2. Install Grille (Continued)

Casement, Awning, and Double-Hung Units

- From either side, begin inserting *Grille Tips* until there are only two remaining tips to insert. Insert last two *Grille Tips* at the same time.

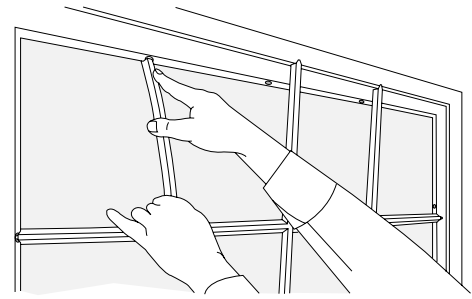

Casement, Awning, and Double-Hung Units

Circle Top™ Units

- Insert *Grille Tips* into upper *Glass Stop* first. Be sure all upper tips go into plastic grommets before snapping remaining tips into grommets on sill *Glass Stop*.
- Slide *Grille* up as far as it will travel and push against spokes and/or hub at base of *Grille* until lower tabs are fully engaged. It may be necessary to pull outward in center of *Grille* while guiding tips into lower grommets.

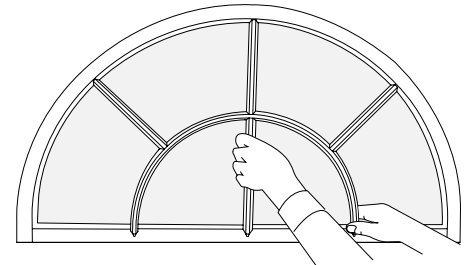
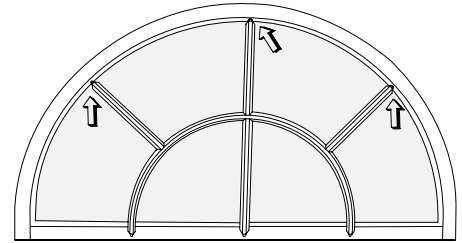

Circle Top Units

Grille Removal

⚠ WARNING

Use of ladders and/or scaffolding and working at elevated levels may be hazardous. Follow equipment manufacturer's instructions for safe operation.

Casement, Awning, and Double-Hung Units

- *Grilles* may be removed for cleaning of glass. To remove *Grille*, pull outward on center of *Grille* while lifting tabs out of grommet area one at a time.

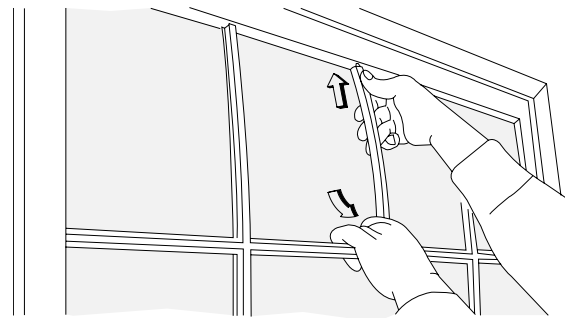

Casement, Awning, and Double-Hung Units

Circle Top™ Units

⚠ CAUTION

DO NOT remove top *Grille Tips* first. Tip breakage could occur.

- *Grilles* may be removed for cleaning of glass. To remove *Grille*, pull outward on center of *Grille* while lifting tabs upward and out of plastic inserts one tip at a time. When all spokes and hub are disengaged at sill, pull *Grille* down and out of window.

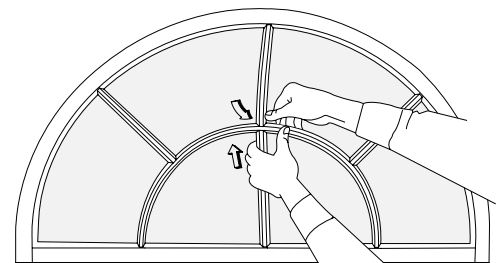

Circle Top Units