

Installation Instructions for:

- **Product Series**

400 Series

- **Product Type**

Tilt-Wash Picture and Transom Windows
 without Installation Flanges

- Read these instructions before starting procedure.
- For additional information visit www.andersenwindows.com.
- For questions call 1-888-888-7020.
- Para ver la versión, en español, visite andersenwindows.com

Parts Included:

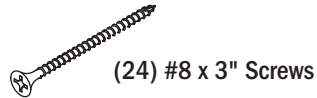
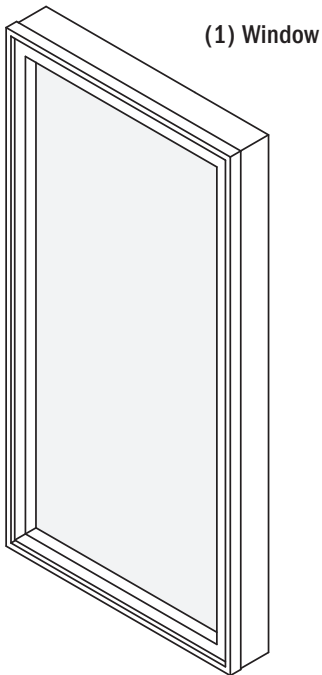

Tools Needed:

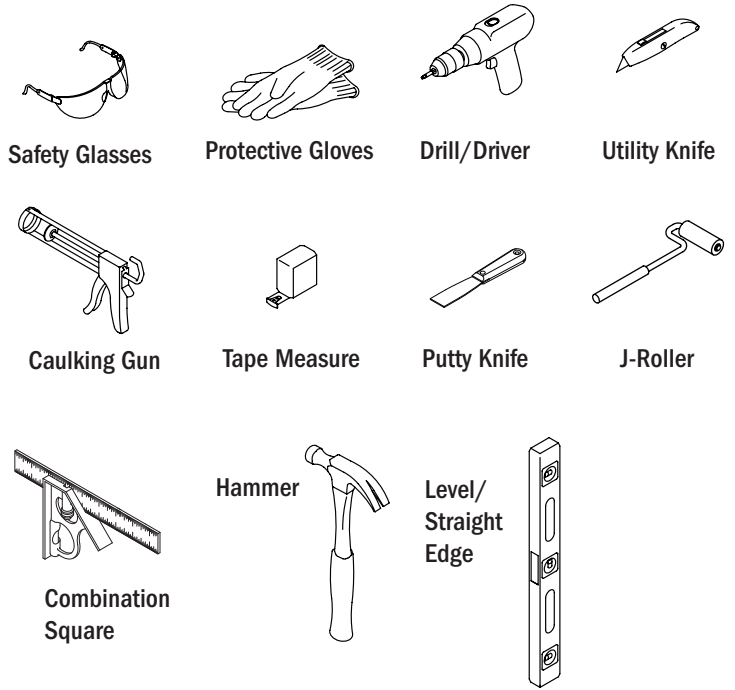

Supplies Needed:

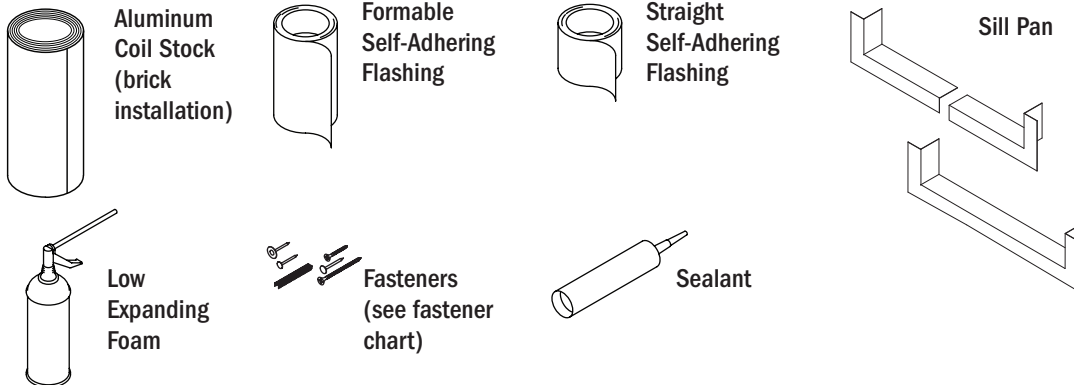

FASTENER CHART

INSTALLATION THROUGH THE JAMB ANCHORING REQUIREMENTS (select one)

Fastener	Substrate	Minimum Head	Minimum Shank	Minimum Embedment to Structural Framing	Steel Type/Coating	Spacing
Wood Screw	Wood	5/16"	#8	1-1/2"	Galvanized, Zinc Chromate, *Stainless Steel, *Ceramic Coated	Every Installation Hole
Self-Tapping Metal Screw	Metal	5/16"	#8	3 Full Threads		
**Concrete Screw	Masonry	5/16"	3/16"	1-1/4"	n/a	

SCREW PACK CONTENTS - Fasteners Provided for Unit Installation

Description	Size	Length	Steel Type	Finish/Color	Head	Tip Type	Driver Bit
Installation Screw	#8	3"	Zinc Chromate	n/a	Pan	Standard	#2 Phillips

Use the correct fastener driver based on the selected fastener's head type.

Size pilot and clearance holes based on the selected fastener's shank diameter as needed.

*Use 300 series stainless steel or ceramic coated fasteners when fastening to treated lumber.

**Follow fastener manufacturer's anchoring recommendations (i.e. spacing, edge distance, hole depth, etc.)

Important Safety and Product Information

for Andersen® Windows and Doors



This is the Safety Alert Symbol used to alert you to potential injury hazards. Obey all safety messages that follow this symbol to avoid possible injury or death.

Signal Word and Consequence

COULD

 **WARNING**
 Result in: Major Injury/Death

COULD

 **CAUTION**
 Result in: Minor Injury

COULD

NOTICE
 Result in: Product or Property Damage

IMPORTANT
 Procedure and Product Information

Read this Important Safety and Product Information completely before starting.

Safety and Product Information Index

- Tools
- Handling
- Installation
- Sealing
- Fastening
- Finishing
- Glass
- Protective Film
- Cleaning
- Use/Operation
- Joining
- Product Information

- Leave this installation instruction with the home/building owner
- For additional support or help please go to: help.andersenwindows.com
- To configure installation instructions go to: andersenwindows.com/installation

Tools

WARNING

- Follow manufacturers' instructions for hand and power tools. Always wear safety glasses. Failure to do so could result in injury, product or property damage.

Handling

WARNING

- Windows and doors can be heavy. Use safe lifting techniques and a reasonable number of people with enough strength to lift, carry, and install window and door products. Heavier windows and doors will require mechanical assistance. Failure to do so could result in injury, product or property damage.
- **DO NOT** lift or carry window or door by the exterior trim or extension jambs. Doing so could result in injury, product or property damage.
- Windows, doors, and installation components can have sharp edges. Wear protective equipment when handling. Failure to do so could result in injury.

Installation

WARNING

- Use caution when working at elevated heights and around window and door openings. Follow the manufacturers' instructions for ladders and scaffolding. Failure to do so could result in injury or death.
- Support window or door in opening at all times until fully fastened. Failure to do so could result in window or door falling out causing injury, property or product damage.
- Windows and doors have small parts (e.g. hole plugs, operator spline caps, fasteners, etc.). Small parts if swallowed could pose a choking hazard to young children. Dispose of unused, loose, or easily removed small parts. Failure to do so could result in injury.

Thank you for choosing Andersen.

Please leave this document with building owner.

Installation (Continued)

NOTICE

- Andersen head flashing and installation flanges **DO NOT** take the place of window and door flashing tape or liquid flashing. Window or door must be properly flashed and sealed with a material compatible sealant for protection against water and air infiltration. Failure to do so could result in product or property damage.
- **DO NOT** set window or door directly on installation flange. Doing so could affect product performance, and could result in product or property damage.
- **DO NOT** set window directly on sill plate. Elevate window with shims under the side jambs. Failure to do so could affect operation and product performance, and could result in product damage.
- Window or door must be properly shimmed. Failure to do so could affect operation and product performance, and could result in product damage.
- A continuous full perimeter interior seal between window or door frame and opening is required. Failure to do so will affect product performance, and could result in product or property damage.
- Protect window and door sills during installation and throughout construction. Failure to do so could result in product damage.
- **DO NOT** remove window or door packaging material until instructed to do so. Doing so could result in product damage.

Sealing

CAUTION

- Follow instructions of foam, sealant, and flashing manufacturers regarding safety, material application, compatibility, and periodic maintenance for continued weather resistance of their products. Failure to do so could result in injury, product or property damage.

NOTICE

- Clean and prepare surfaces receiving sealant following sealant manufacturer's instructions. Failure to do so could result in water infiltration causing product or property damage.

Fastening

WARNING

- Metal fasteners and components could corrode when exposed to preservative-treated or fire-retardant treated lumber. Use approved fasteners and components to fasten window or door. Failure to do so could cause a failure resulting in injury, product or property damage.
- Fastener must attach to a structural framing member with a 1-1/2" minimum fastener embedment. Failure to do so could result in injury, product or property damage.
- **DO NOT** remove screws that attach installation clips or gusset plates to window or door frames. Doing so could result in injury, product or property damage.

NOTICE

- Use masonry screws when fastening directly into masonry or through a buck into masonry. Failure to do so could affect product performance, and could result in product or property damage.
- **DO NOT** over drive screws or nails. Doing so could result in product damage.
- Fasteners must be attached to a structural framing member. Failure to do so will reduce the structural performance to less than published values and could affect product performance, and could result in product or property damage.

Finishing

NOTICE

- **DO NOT** stain or paint weatherstrip, vinyl, glass, or hardware. Doing so could result in product damage.
- Read and follow finish manufacturer's instructions and safety information. Failure to do so could result in product damage.
- **DO NOT** over load brush with stain or paint when finishing. Doing so could allow finish to wick between glass stop or grille, and glass.

Finishing (Continued)

NOTICE

- Finish unassembled unfinished gliding patio doors and MultiGlide™ patio doors prior to installation. Some surfaces are not accessible after installation. For all other products not mentioned above, finish all wood surfaces immediately after installation.

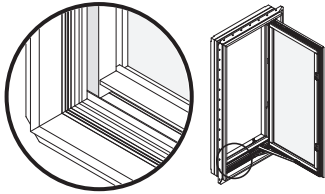

Unfinished wood will deteriorate, discolor, and could bow or split. Some surfaces are hidden from view.

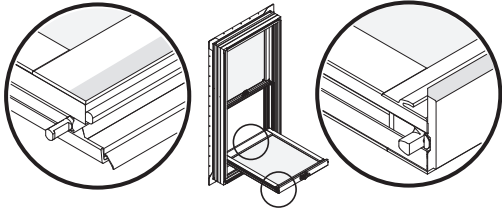

Protective Film

WARNING

- **DO NOT** place suction grips over film seam. Suction grips will not hold if placed over film seam to lift or move window or door. Window or door will fall and could result in injury, product or property damage.



- **DO NOT** remove protective film near flammable materials. Static charge created when removing film can ignite flammable materials or cause a shock. Doing so could result in injury, product or property damage. See warning label on glass.

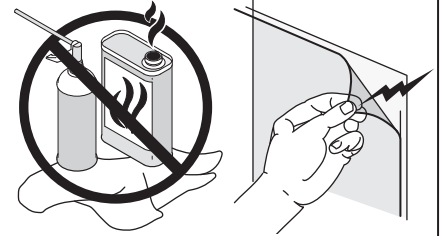

- Dispose of protective film immediately after removing. Failure to do so could pose a suffocation hazard to children.

Glass

WARNING

- Unless specifically ordered, Andersen windows are not equipped with safety glass, and if broken, could fragment causing injury. Many laws and building codes require safety glass in locations adjacent to or near doors. Andersen windows are available with safety glass that could reduce the likelihood of injury when broken. Information on safety glass is available from your local Andersen dealer.

- Tempered or laminated safety glass is not standard for windows and must be special ordered. Check local building codes for required locations. Failure to do so could result in injury, product or property damage.

NOTICE

- **DO NOT** apply any type of film to insulating glass. Doing so could cause thermal stress conditions and result in glass damage. Shading devices (e.g. insulated coverings, shutters, etc.) could also cause thermal stress and condensation causing deterioration of windows or doors.

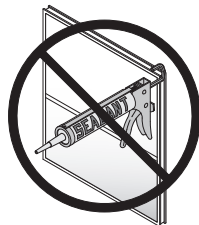

- **DO NOT** use sealants on exterior or interior glass surface.

NOTICE

- **DO NOT** remove protective film until after construction is completed. Doing so could allow glass to be damaged.

Cleaning

NOTICE

- Acid solutions used for cleaning masonry or concrete will damage glass, fasteners, hardware, and metal flashing. Protect window or door and follow cleaning product manufacturer's instructions. If acid contacts window or door, wash all surfaces immediately with clean water.

- **DO NOT** use metal razor blades to clean glass surface. Glass damage could result.

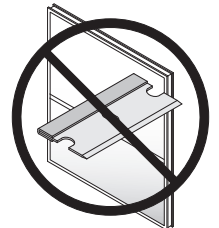

- **DO NOT** use or apply solvents, abrasives, harsh chemicals or cleaners to glass, sash, panels, frame, or window or door components. Doing so will result in product damage. For a list of recommended cleaners go to: andersenwindows.com

Use/Operation

WARNING

- **DO NOT** stand in front of or near windows or doors during a storm. Doing so could result in injury. Accessories such as grilles, art glass, and insect screens could dislodge and become airborne if window or door is impacted by wind-borne debris from severe storms or hurricane strength winds. In the event of a storm, remove all accessories from windows or doors and move to a safe location.

- **DO NOT** install air conditioner in window. Doing so could result in injury, product or property damage.



- Wind load brackets must be flipped out when not tilting or cleaning. If wind load brackets are not flipped out, window could blow in resulting in potential injury and/or product damage.

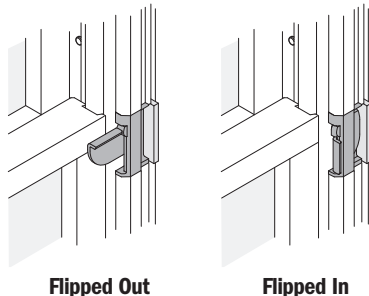

CAUTION

- **DO NOT** attach objects or accessories to window or door except Andersen® products specifically designed for the window or door. Doing so could result in injury, product or property damage.

Joining

WARNING

- **DO NOT** join any window or door, horizontally or vertically, to any window or door not designed for joining. Doing so could result in injury, product or property damage.

- Joined windows or doors must be individually supported in the opening. Failure to do so could affect operation and product performance, and could result in product or property damage.

Product and General Information

IMPORTANT

- Buildings constructed prior to 1978 could contain lead paint which could be disturbed during window or door replacement. For more information on proper management of lead paint, go to: www.epa.gov/lead

- Instructions may not be right for all installations due to building design, construction materials, or methods used and/or building or site conditions. Consult a contractor or architect for recommendations.

- Installation flanges may need to be removed for some installations. (e.g. masonry, replacement), or where exterior finish is already applied (e.g. siding, brick veneer, stucco).

- Installation flange on the window or door alone will not properly flash and seal the window or door.

- **DO NOT** remove band, plastic ties, or packing clips from window or door until instructed.

- **DO NOT** remove performance (NFRC) label until after final inspection. Doing so could delay final inspection and sign-off by the code official.

- Check with your local building code official to identify and confirm compliance with local building code requirements.

- Contact local authorities or waste management company for proper recycling and disposal instructions for removed window or door.

- Clean glass using liquid glass cleaner.

- Clean exterior frame, sash, panels, and insect screens using mild detergent and water with a soft cloth or brush.

- For hard to clean areas, use a nonabrasive cleaner.

- Extension jambs can be factory applied on some windows or field applied prior to installation. **DO NOT** apply extension jambs prior to window or door installation that will be fastened with installation clips. Doing so could prevent access to installation clips for fastening.

- For extension jamb application refer to instructions included with part(s) or go to: andersenwindows.com

- Protective film is not present on all windows or doors.

- Remove protective film by peeling from seam or corner. Use a plastic scraper to start if needed.

- Remove protective film within six (6) months of installation and when temperature is above 32° F.

- Protective Film is not a substitute for masking.

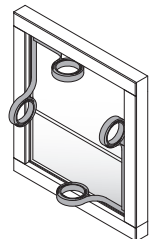

1

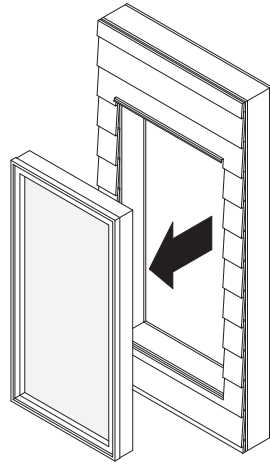

Remove existing window. Preserve existing weather resistant barrier, if present. Clean entire rough opening of debris and old sealant. Repair surfaces that will be sealed or anchored to by new window.

2

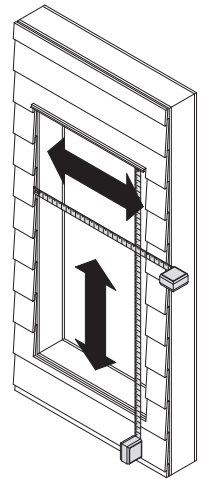

Check that the opening is sized correctly. Allow additional space for flashing thickness, installation clips, joining components, and their fasteners.

3

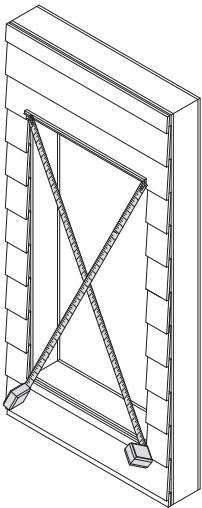

Check that the opening is square. The diagonal measurements should be within 1/8".

4

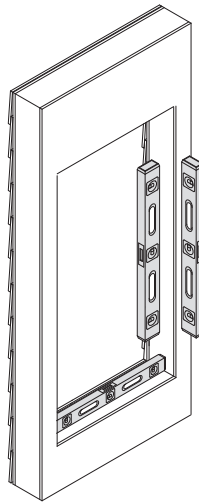

Check that the opening is plumb and level.

5

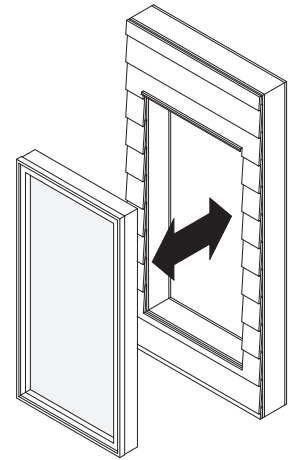

Dry fit window.

6

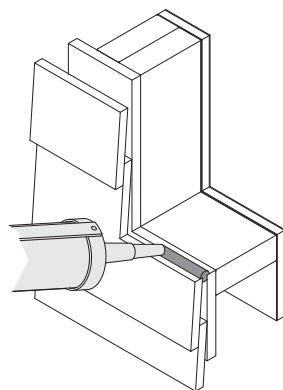
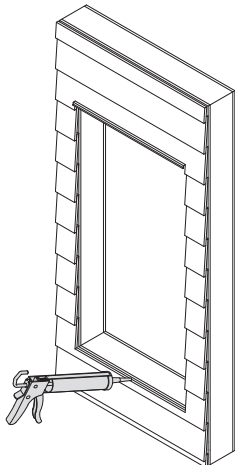

Lap Siding

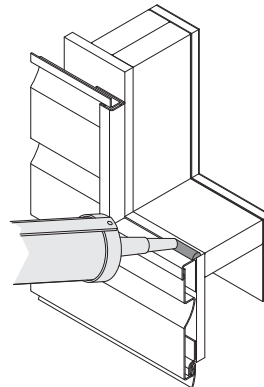

Manufactured Siding

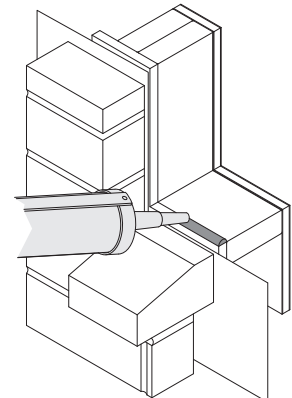

Brick

Apply sealant at bottom, as shown. Quickly go to next step.

7

Lap Siding / Manufactured Siding

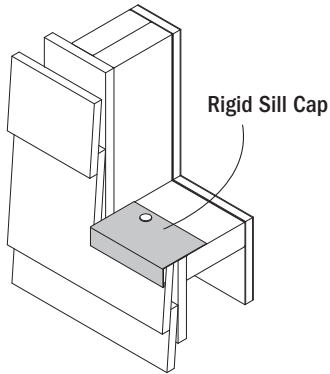
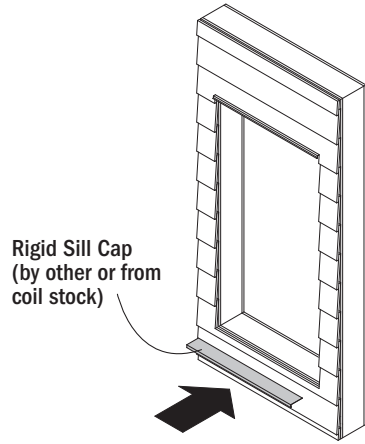

Lap Siding

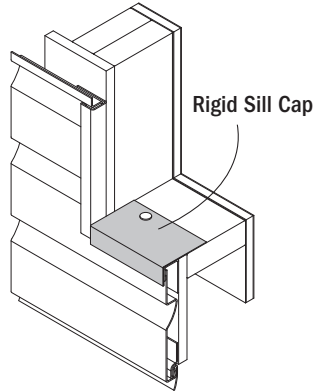

Manufactured Siding

Apply rigid sill cap (full width) to sill, extending over exterior cladding. Tack in place.

Brick

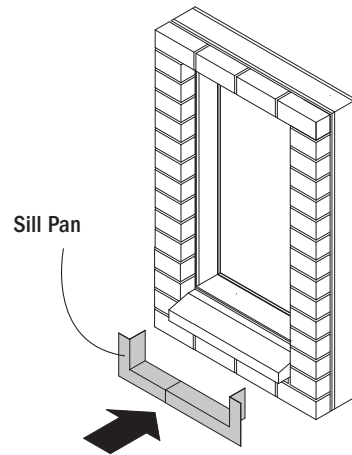

or

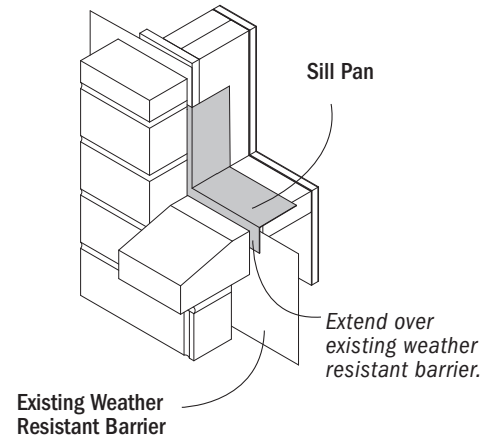

Brick

Apply sill pan to sill, extending over existing weather resistant barrier.

8

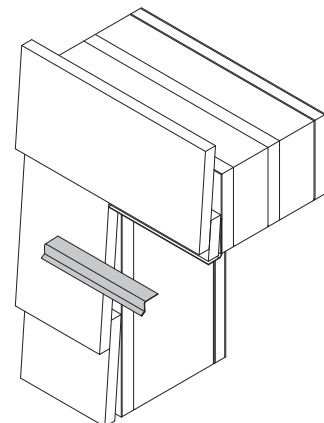
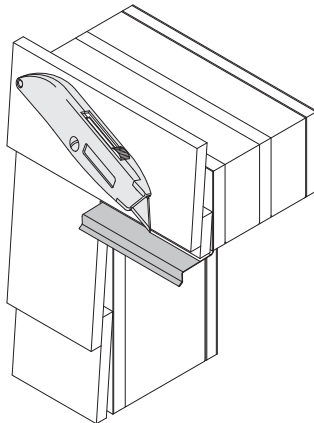
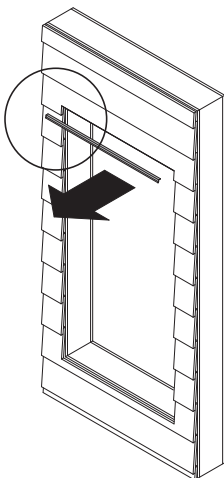

If present, score existing drip cap and remove. Dispose of properly.

9

NOTICE

Apply self-adhering flashing. Make sure there are no wrinkles or voids. Failure to do so may result in product or property damage.

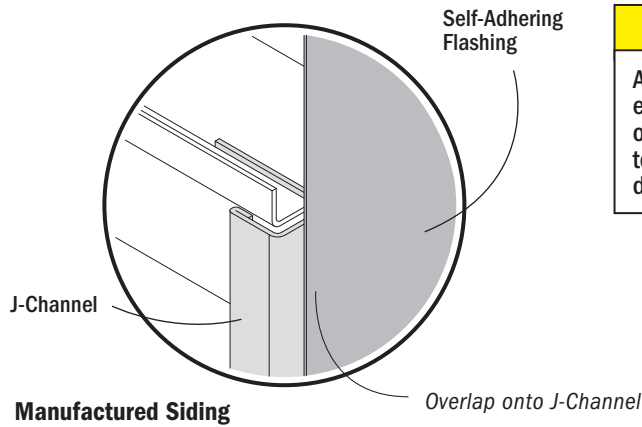
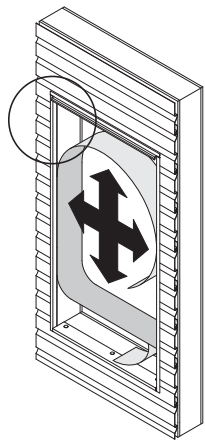
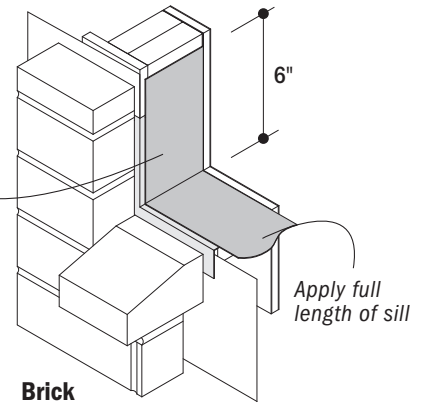
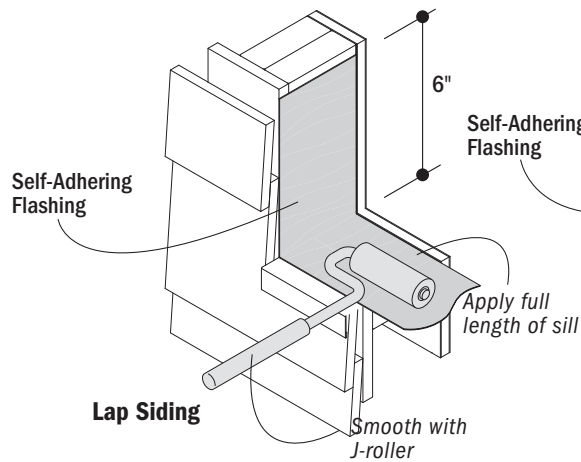
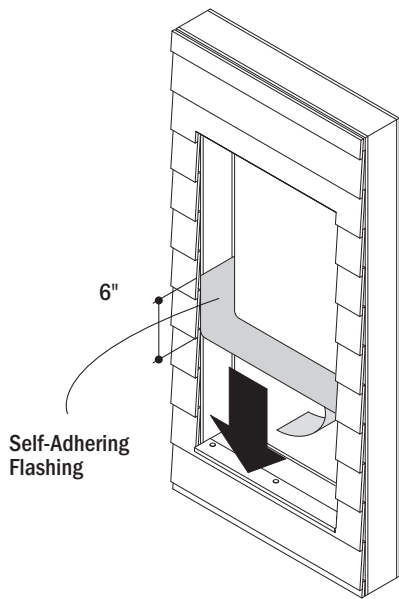

CAUTION

Apply formable self-adhering flashing around entire opening for manufactured siding, overlapping onto siding's J-channel. Failure to do so may result in product or property damage.

For lap siding and brick installation, apply flashing at sill, 6" up each side and full length of sill, using firm pressure. For manufactured siding, apply self-adhering flashing around entire opening, overlapping onto siding's J-channel.

10

Brick Only

$$\text{Rough Length} = \text{Opening} - 1/4" \text{ Height}$$

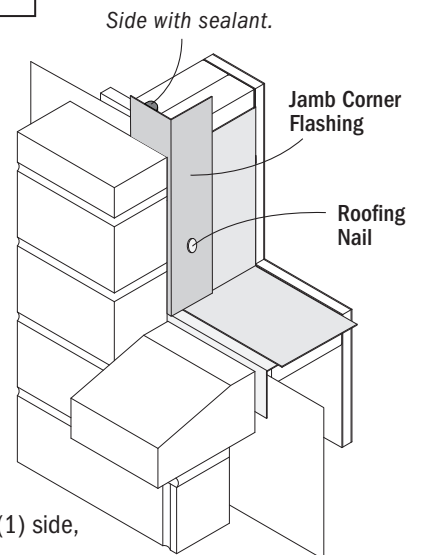
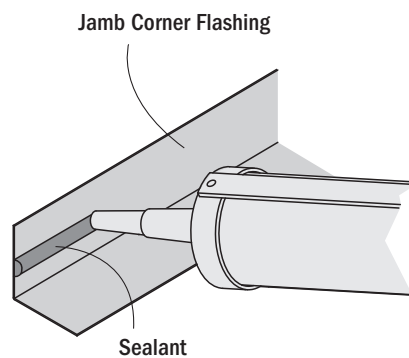
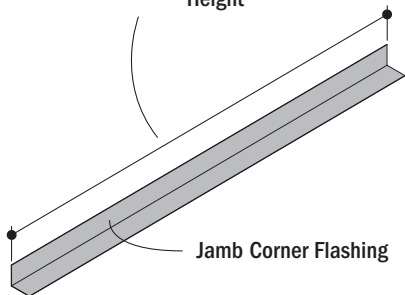

Form two (2) jamb corner flashings from aluminum coil stock and apply sealant bead, full length, to one (1) side, as shown. Apply jamb corner flashing at sides, as shown. Tack in place using roofing nails.

11

Brick Only

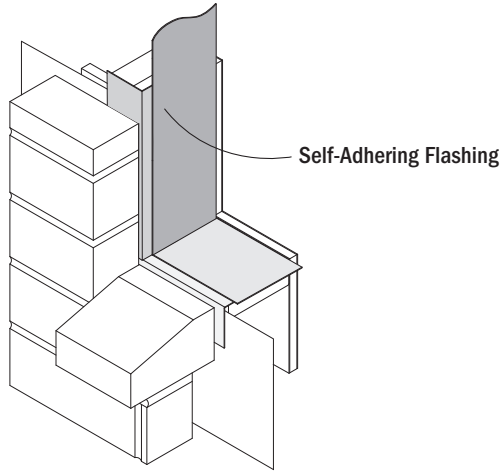

Apply self-adhering flashing, full height, to sides of rough opening, making sure to overlap the jamb corner flashing.

12

Lap Siding Only

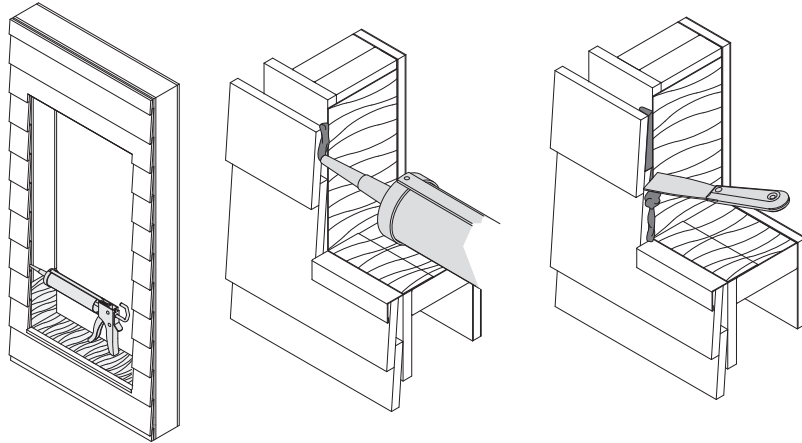

Apply sealant full perimeter to bridge gap between siding, sheathing, and flashing. Tool smooth using a putty knife.

Brick Only

or

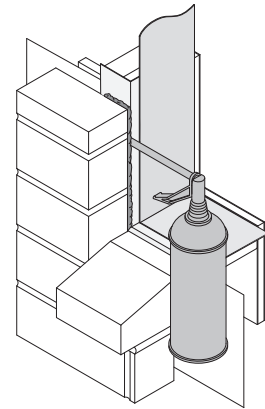

Apply low expanding foam to bridge gap between brick and corner flashing at sides and head only.

13

Picture Windows

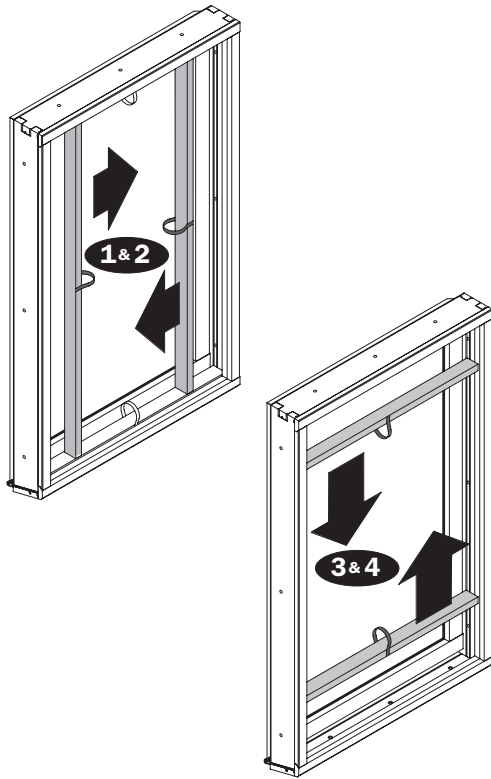

Transom Windows

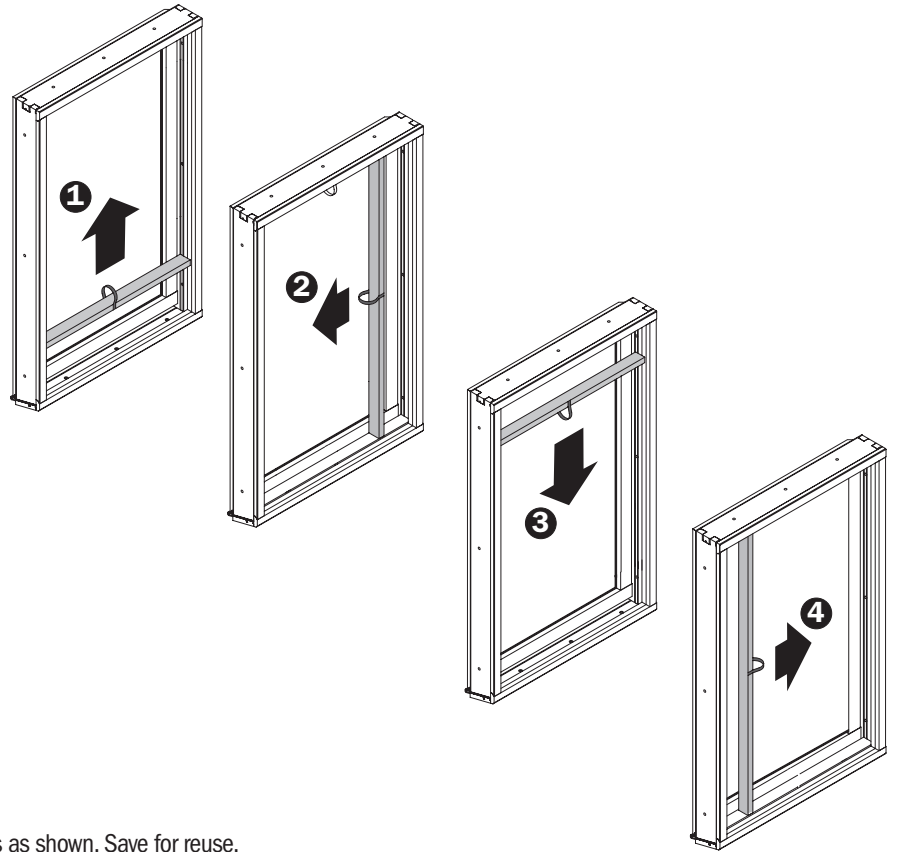

Remove jamb fillers in succession to access installation holes as shown. Save for reuse.

14

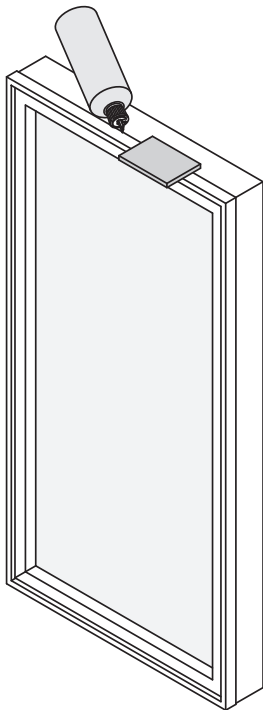

Clean frame cladding, full perimeter, using soap and water or a non-abrasive solvent free cleaner.

15

Brick Only

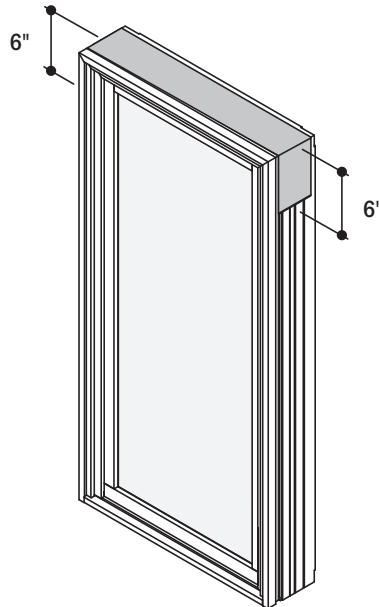

For brick installations, apply self-adhering flashing to top of single units, full width and extending 6" down each side.

16

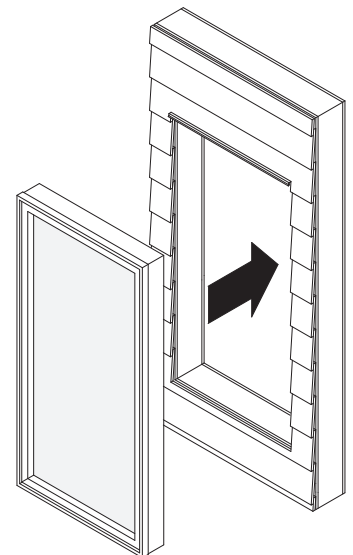

Center window in opening.

17

NOTICE

Place shims directly under side jambs. At gusset plate locations, place shims to not interfere with gusset plate screws. Failure to do so could result in product damage and could result in poor operation.

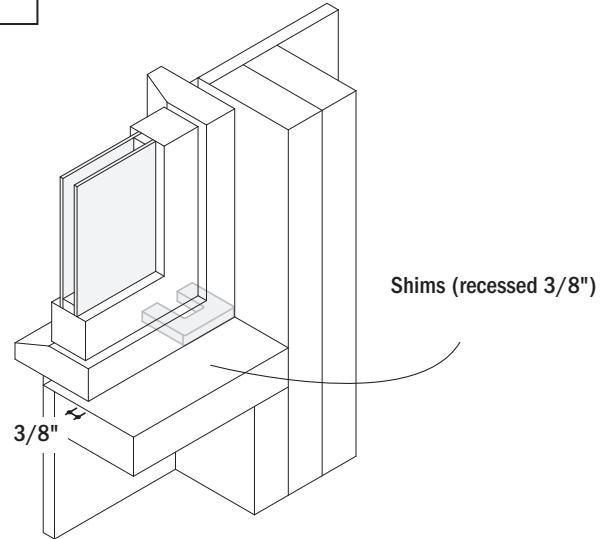
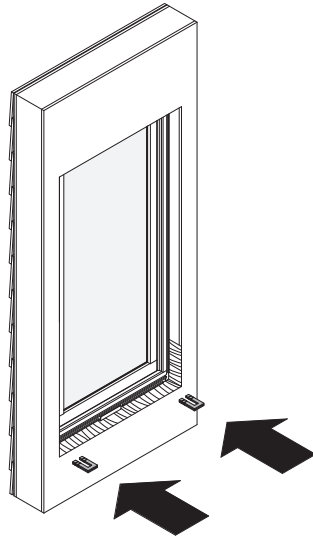

Prepare shims to allow for a 3/8" space for interior sealing as shown.

Place shims on the bottom of the opening under the side jamb locations inset 1/4" from each side.

Make sure shims are positioned under the side jambs and integral or joined combination locations as shown.

18

! WARNING

Fastener must attach to a structural framing member with a 1-1/2" minimum fastener embedment. Failure to do so could result in injury, product or property damage.

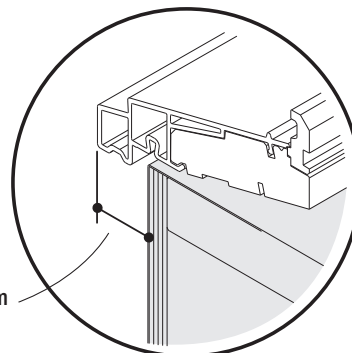
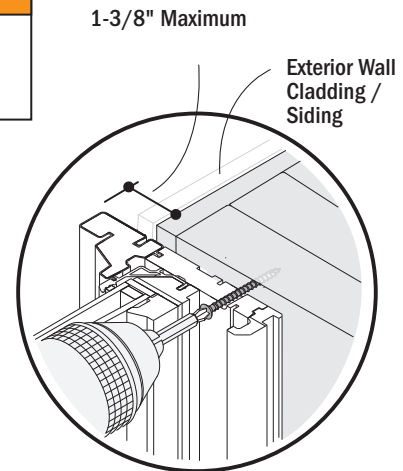
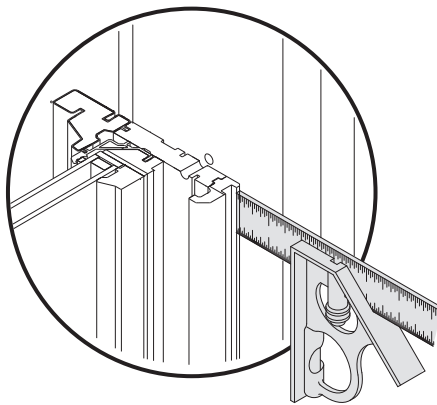
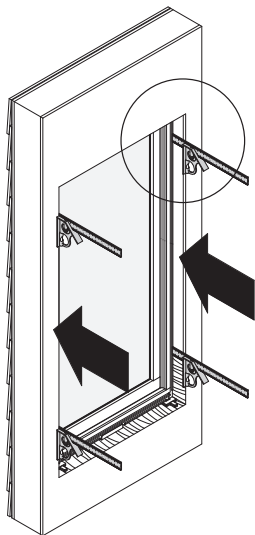

1-3/8" Maximum

Position window at desired depth with a maximum 1-3/8" of frame extending from rough opening. Fasten upper corner to hold in place while shimming. Do not fully tighten.

19

Side Shim Locations

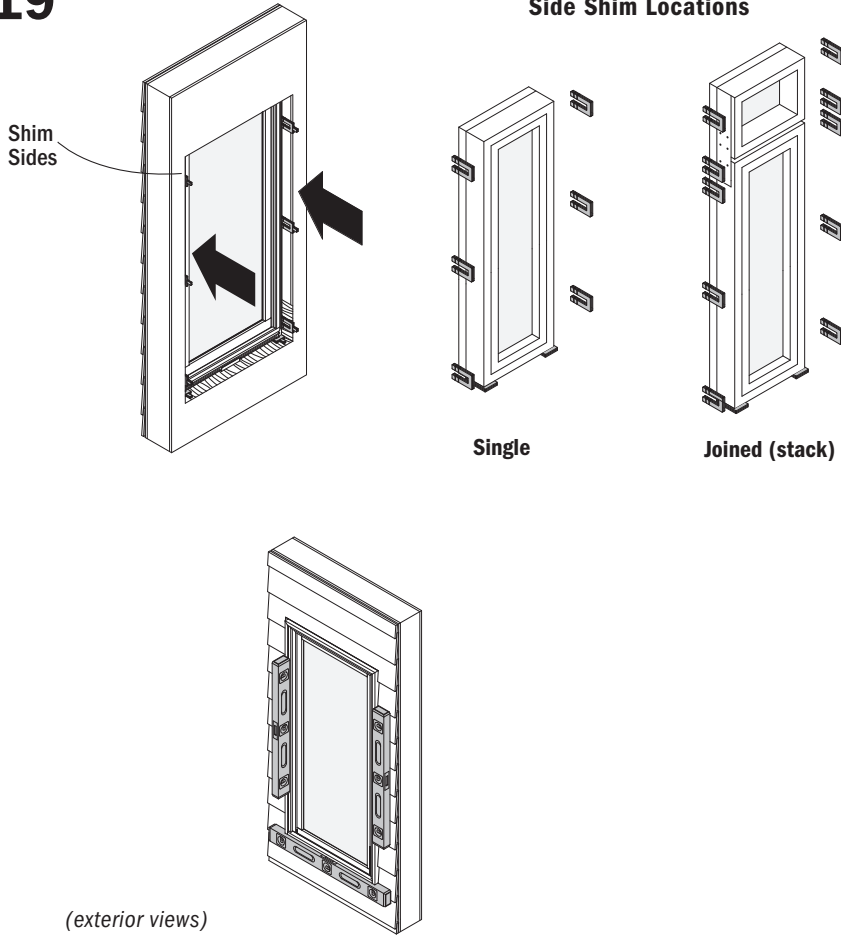

NOTICE

Additional shims and measuring are required on windows 5'-4" in height or taller. Failure to do so could result in poor product performance.

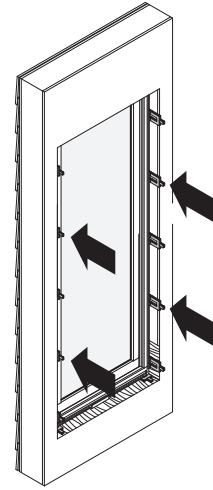

Shim sides of window frame at screw holes using precut shims. **Do not shim at top.** Check for plumb, level, and square. Adjust shims as needed until measurements are within 1/8".

20

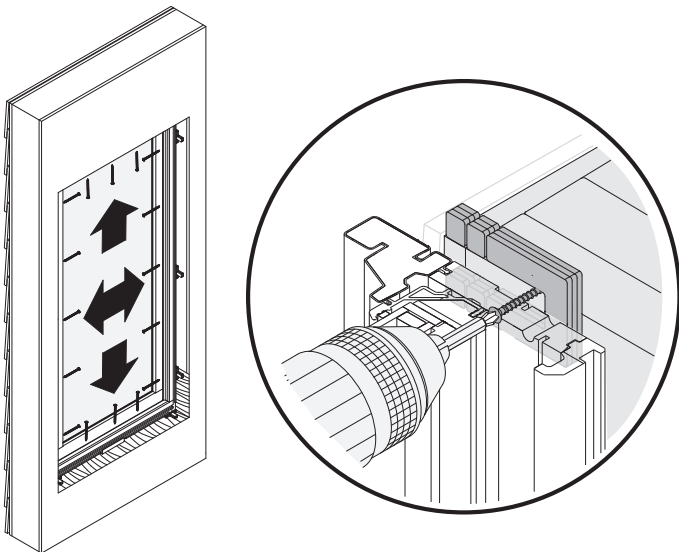

Fasten at all hole locations. See fastener chart for approved fasteners.

21

Picture Windows

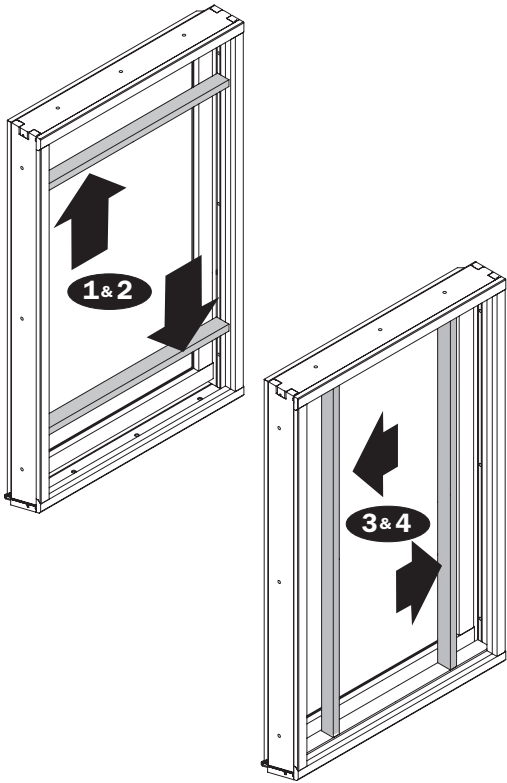

Transom Windows

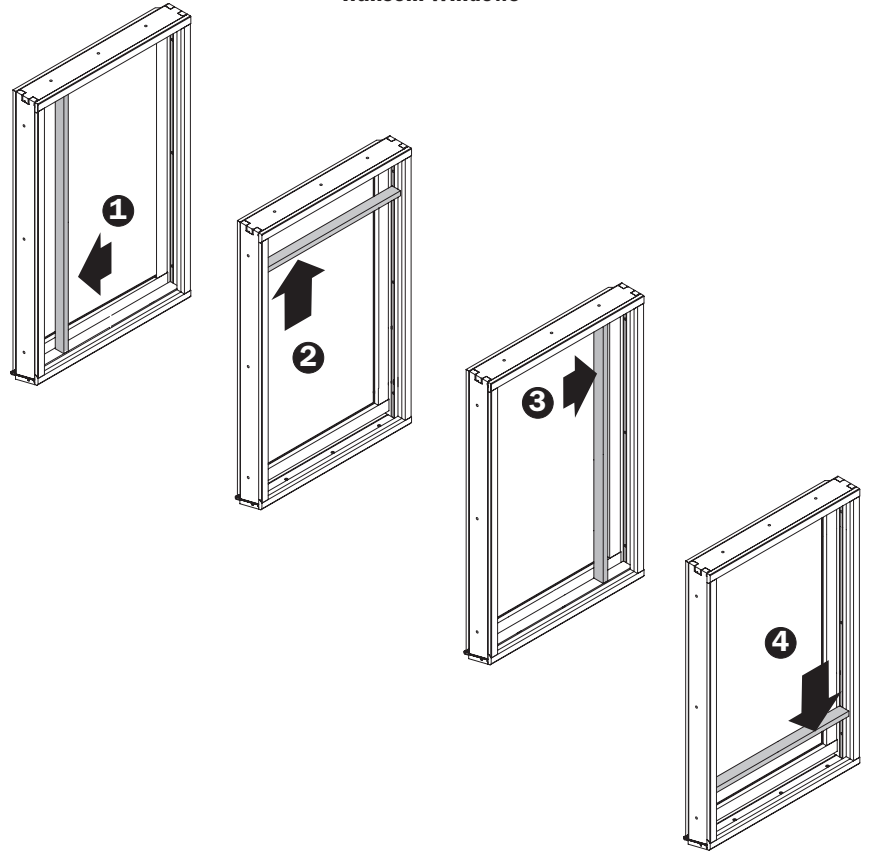

Reapply jamb fillers as shown.

22

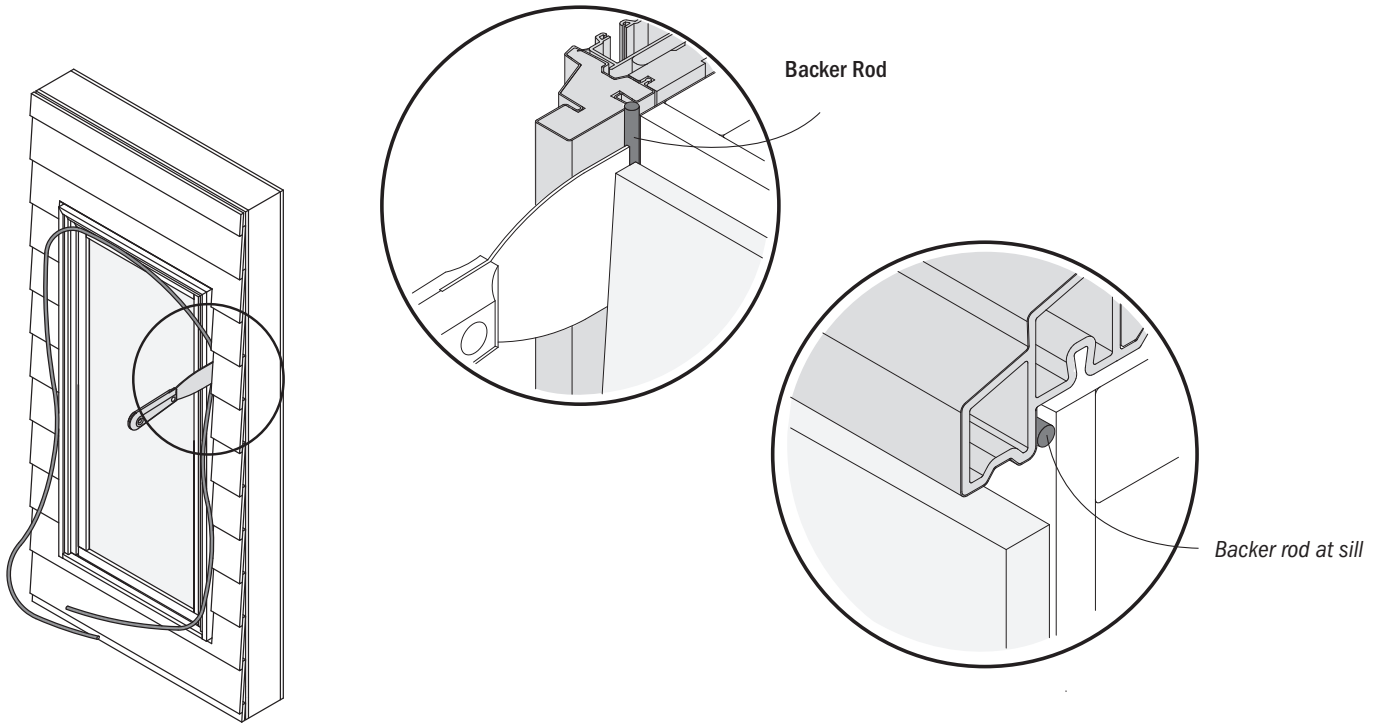

Insert backer rod at sides, top, and bottom.

23

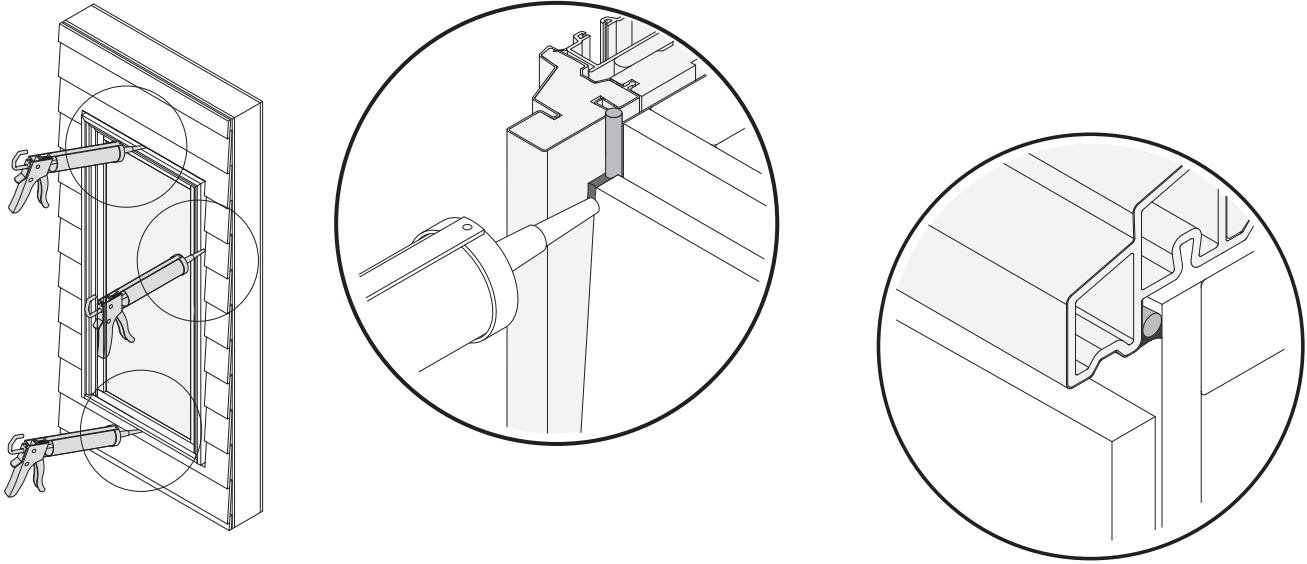

Apply sealant to sides, top, and bottom. Tool smooth, if necessary.

NOTICE

DO NOT overfill with low expanding foam or overpack with backer rod between the frame and opening or between joined windows or doors. Doing so will bow window or door jambs and could result in poor operation and product performance.

24

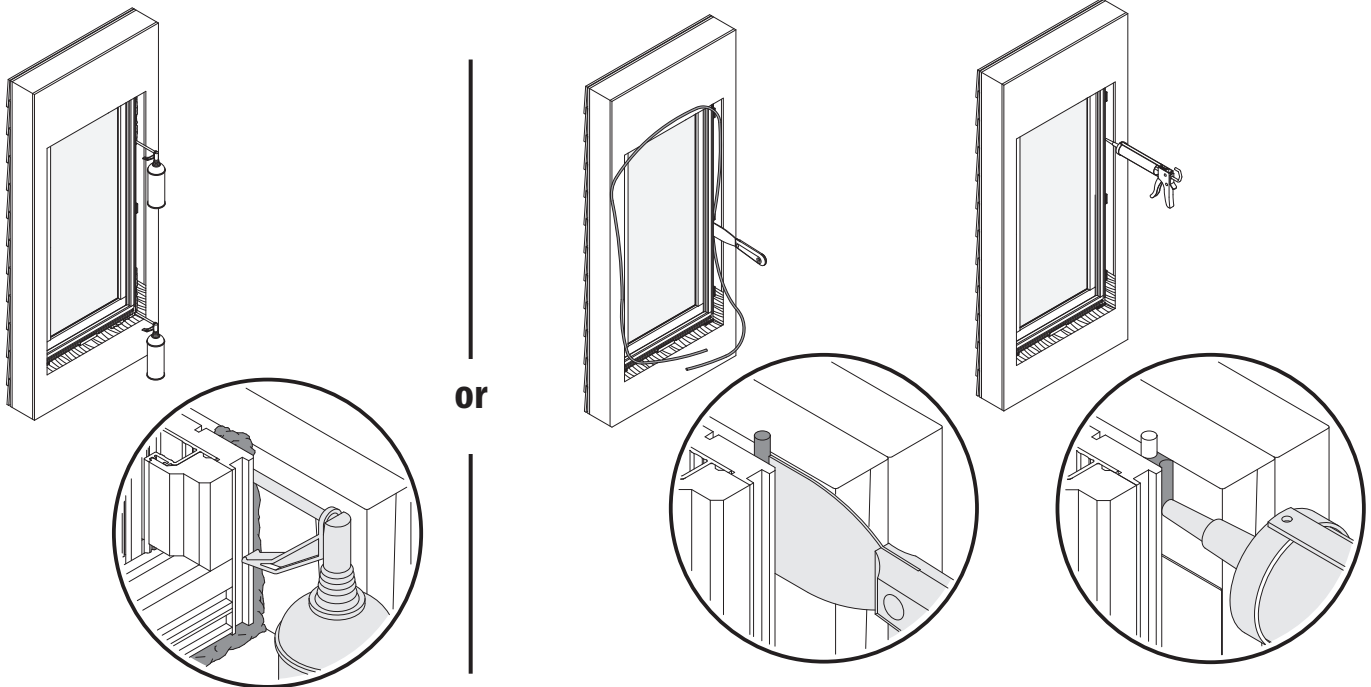

Apply sealant continuously to full perimeter of opening, filling interior 1/3 of cavity as shown using low expanding foam or backer rod and sealant.

► Installation is complete.