

Top and Bottom Rail Weatherstrip Replacement

Product Series: 400 Series Tilt-Wash
 400 Series Tilt-Wash Insert
 Primed Narroline (1962-1970)
 200 Series Perma-Shield Narroline (1968 - 2012)

Read these instructions before starting procedure.
 For additional information visit www.andersenwindows.com.
 For questions call 1-888-888-7020.

Product Type: Double-Hung Windows

Parts Included:

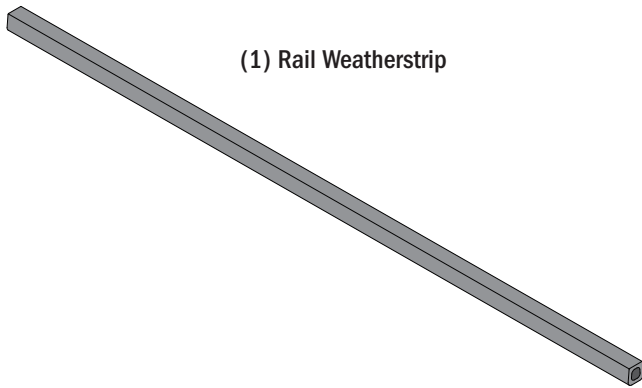

Tools and Supplies Needed:

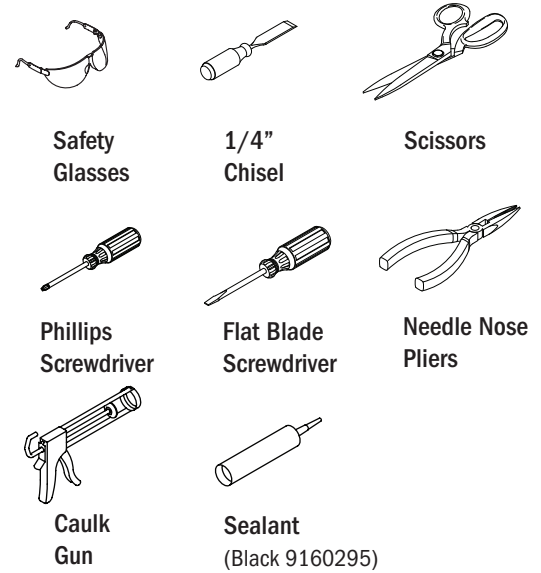

Handling

WARNING

- Windows and doors can be heavy. Use safe lifting techniques and a reasonable number of people with enough strength to lift, carry, and install window and door products. Heavier windows and doors will require mechanical assistance. Failure to do so could result in injury, product or property damage.
- Windows, doors, and installation components can have sharp edges. Wear protective equipment when handling. Failure to do so could result in injury.

Tools

WARNING

- Follow manufacturers' instructions for hand and power tools. Always wear safety glasses. Failure to do so could result in injury, product or property damage.

Installation

WARNING

- Use caution when working at elevated heights and around window and door openings. Follow the manufacturers' instructions for ladders and scaffolding. Failure to do so could result in injury or death.
- Support window or door in opening at all times until fastened. Failure to do so could result in window or door falling out causing injury, property or product damage.
- Windows and doors have small parts (e.g. hole plugs, operator spline caps, fasteners, etc.). Small parts if swallowed could pose a choking hazard to young children. Dispose of unused, loose, or easily removed small parts. Failure to do so could result in injury.

1

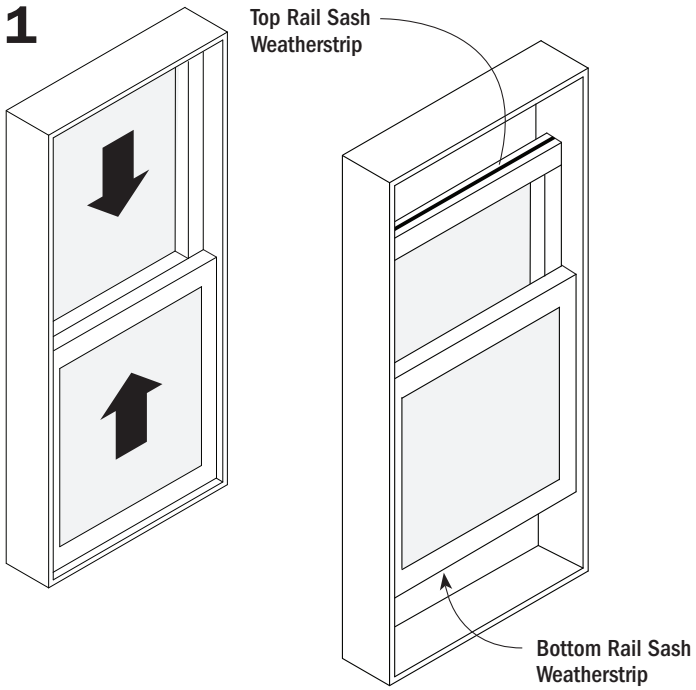

Open sash and locate weatherstrip to replace. Remove sash.

For 400 Series Tilt-Wash Double-Hung and 400 Series Tilt-Wash Double Hung Insert sash removal and reinstallation, see **page 3**.

For Primed Wood Narroline® and 200 Series Perma-Shield Narroline Double-Hung sash removal and reinstallation, see **page 7**.

2

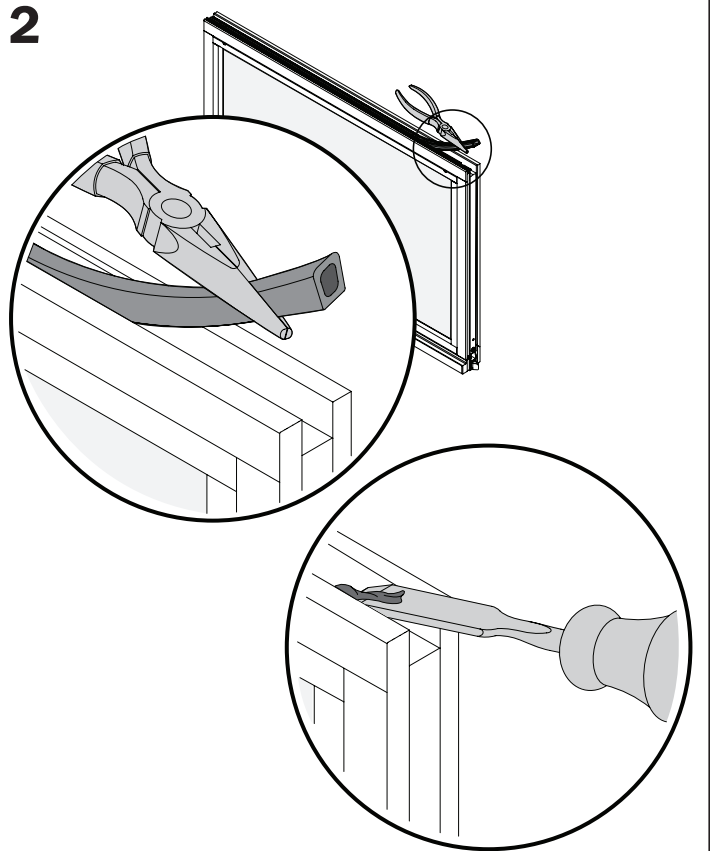

Pull out old weatherstrip using a needle nose pliers. Remove old adhesive/sealant from weatherstrip channel using a chisel.

3

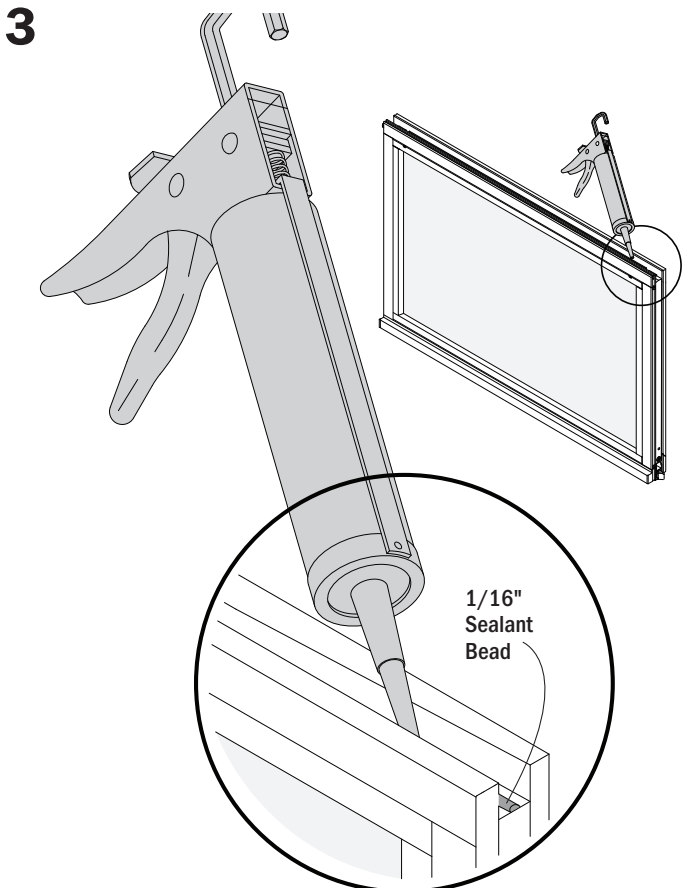

Apply 1/16" bead of sealant along middle of sash channel, full width.

4

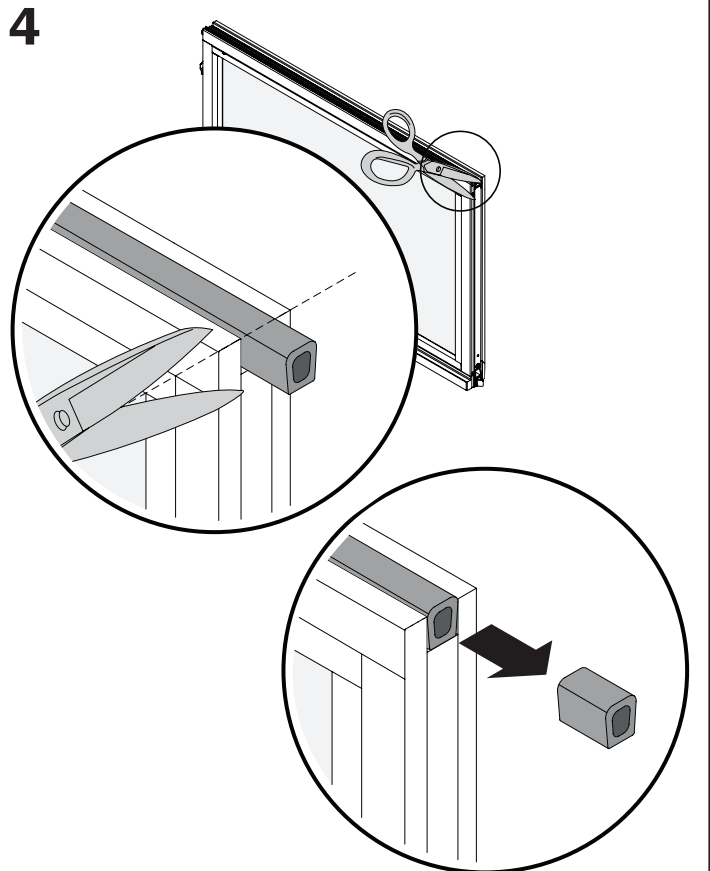

Press new weatherstrip into channel, flush with one end. Cut opposite end flush with end of sash. Reinstall sash.

1

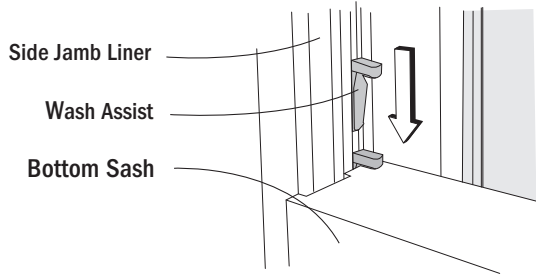
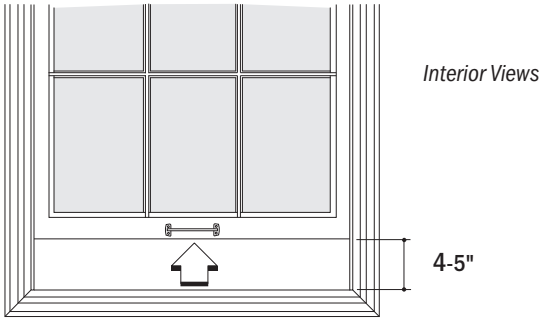

Position bottom sash four to five inches from sill. (Refer to washing instructions in right-hand corner of head jamb.)

Slide both wash assists (one for each side) down from top of side jamb liner until they "snap" in place between the bottom sash and side jamb liner.

2

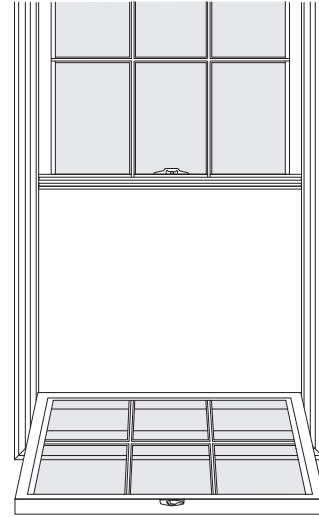

IMPORTANT

Sash must be at a 90° angle to be removed.

Tilt bottom sash in and down, horizontally, to a 90° angle.

3

Depress balancer shoe retainer clip, if present, using a small flat blade screwdriver releasing sash pivot pin on bottom sash.

Raise bottom sash corner two inches above balancer shoe and hold in place.

Repeat steps for opposite side of the bottom sash.

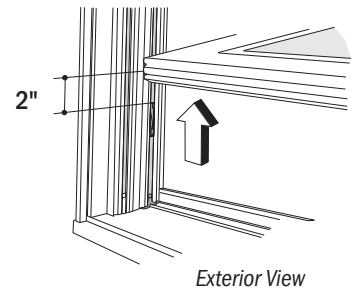
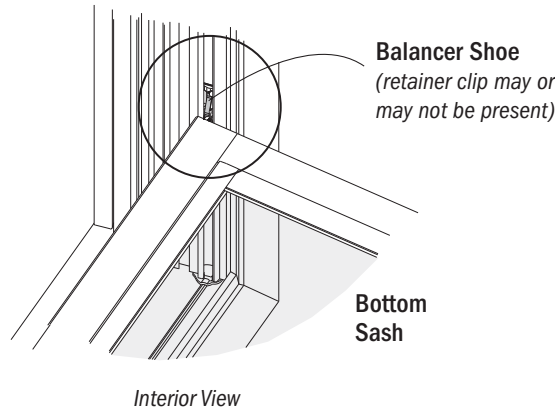

Balancer Shoe (with Retainer Clip)

Retainer Clip

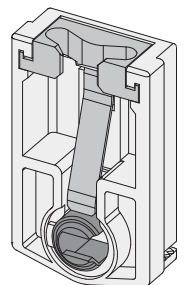
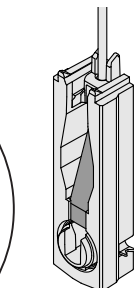
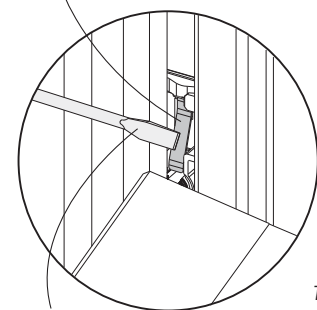

Or

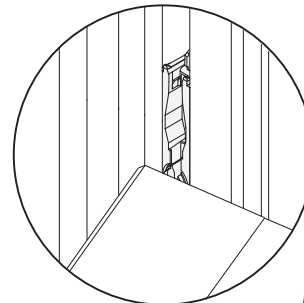

Balancer Shoe for
Tilt-Wash Double-Hung
Insert Windows

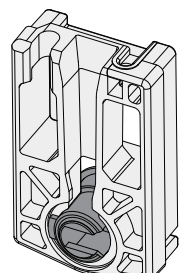

Balancer Shoe for
Tilt-Wash Double-Hung
Windows

4

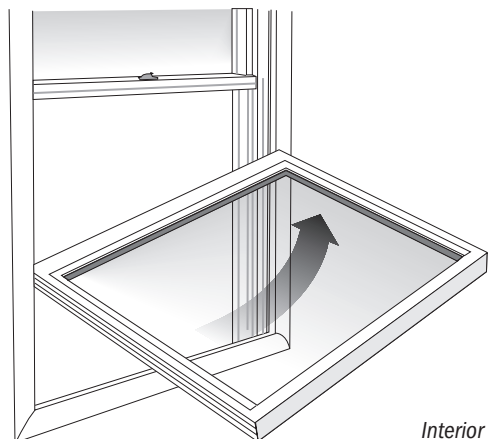

Interior View

When both sash pivot pins are released, lift bottom sash up and out.

For bottom sash reinstallation, proceed to **page 6, step 9**.

For top sash removal or replacement, proceed below to **step 5**.

5

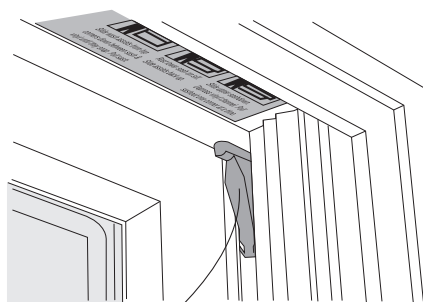

Wash Assist

Side Jamb Liner

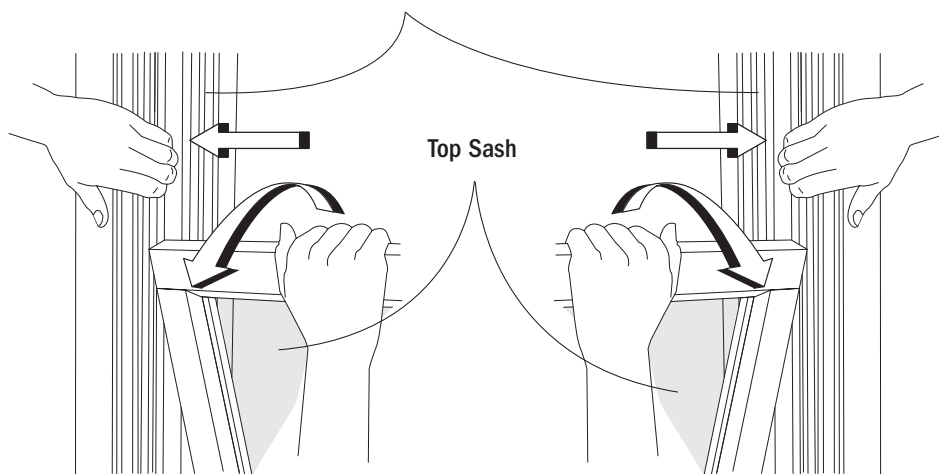

Interior Views

Slide wash assists back to top of window unit.

Position top sash to about five inches from sill.

Holding top right-hand side of top sash, depress side jamb liner with one hand and carefully pull top sash inward until it releases from jamb liner.

Holding top sash in position, depress left-hand side jamb liner and carefully pull top sash inward.

6

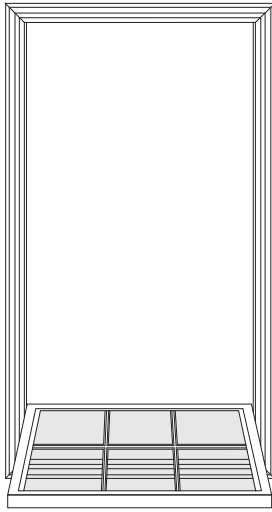

IMPORTANT

Sash must be at a 90° angle to be removed.

Tilt top sash in and down, horizontally, to a 90° angle.

- 7** Depress balancer shoe retainer clip, if present, using a small flat blade screwdriver releasing sash pivot pin on top sash.
- Raise top sash corner two inches above balancer shoe and hold in place.
- Repeat steps for opposite side of the top sash.

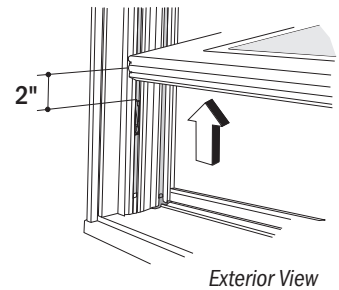
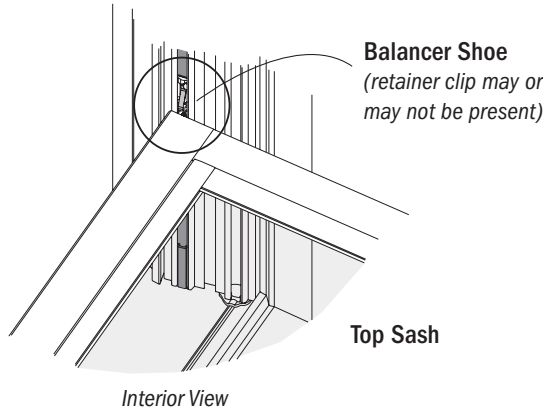

Balancer Shoe (with Retainer Clip)

Retainer Clip

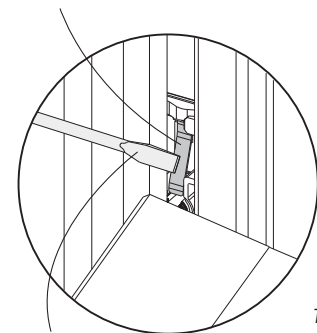

Screwdriver

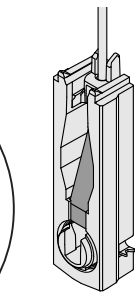

Balancer Shoe for Tilt-Wash Double-Hung Insert Windows

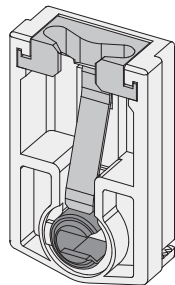

Balancer Shoe for Tilt-Wash Double-Hung Windows

Or

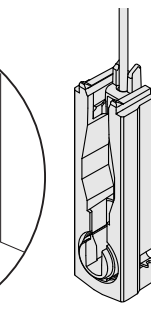
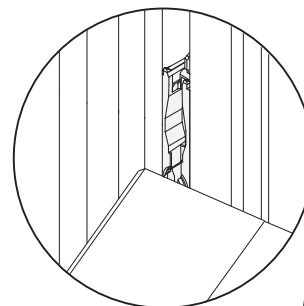

Balancer Shoe for Tilt-Wash Double-Hung Insert Windows

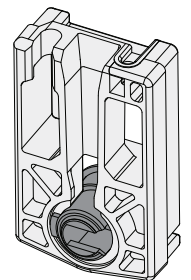

Balancer Shoe for Tilt-Wash Double-Hung Windows

8

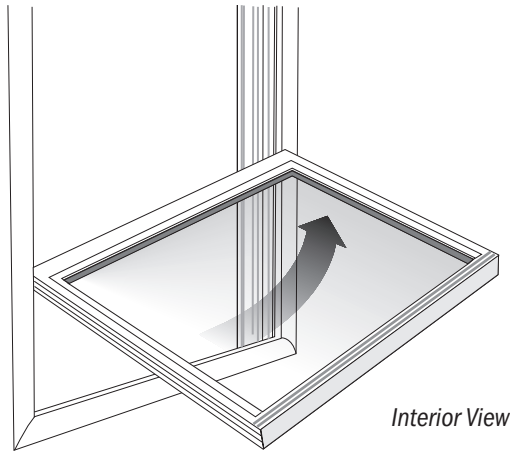

Interior View

When both sash pivot pins are released, lift top sash up and out.

9

IMPORTANT

Sash must be installed at 90° angle to be rotated up.

Top Sash Reinstallation

With exterior side of top sash facing up, place sash pivot pins, one at a time, into balancer shoes in outer channel of jamb liner.

Press down on bottom corners of sash to seat sash pivot pins in balancer shoes.

Tip sash up into frame until firmly engaged in jamb liner

Slide sash to top.

Bottom Sash Reinstallation

CAUTION

Use caution when tipping bottom sash into opening to prevent pinching fingers between top and bottom sash.

With exterior side of bottom sash facing up, place sash pivot pins, one at a time, into the balancer shoes located in the inside channel of the jamb liner.

Press down on bottom corners of sash to seat sash pivot pins in balancer shoes before tilting sash up.

When sash pivot pins are engaged, tip sash up into place until firmly engaged in jamb liner.

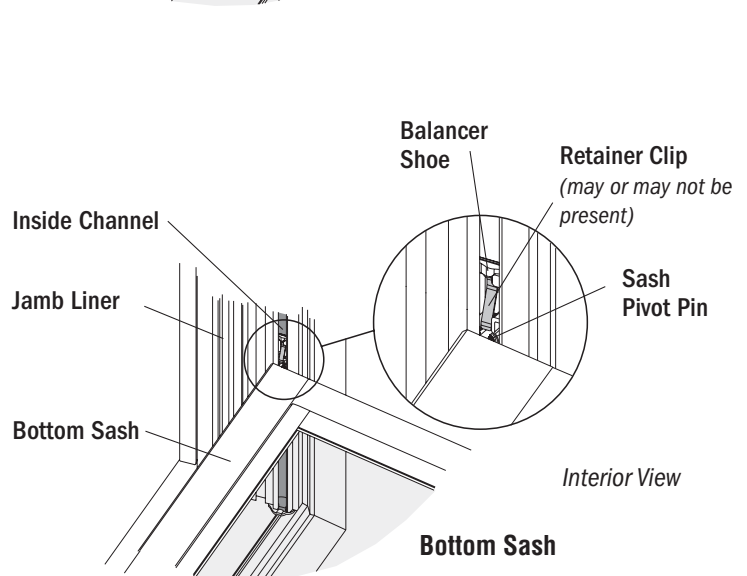
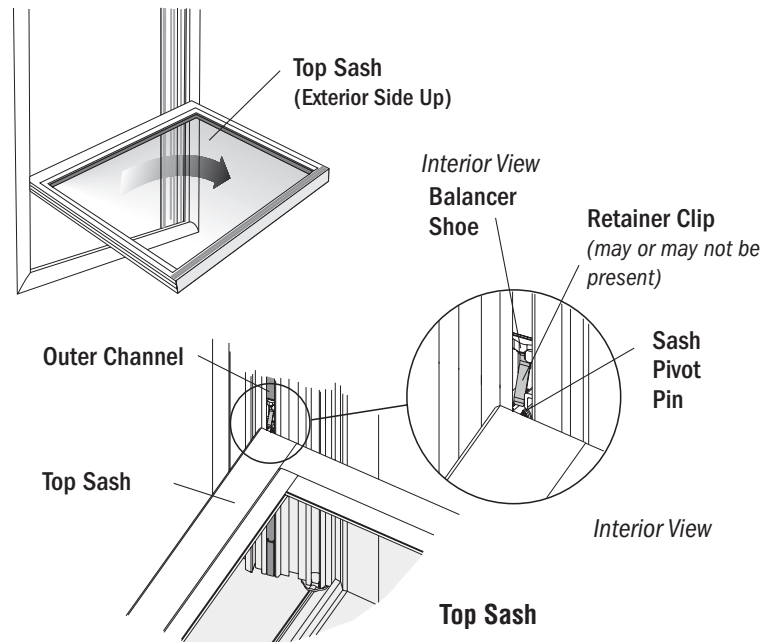

► 400 Series Tilt-Wash Double-Hung and 400 Series Double-Hung Insert Sash Removal and Reinstallation is complete.

1

Units with DP50 Sill Stop

DP50 Sill Stop over Prefinished Sill Stop

Check along sill for existence of a DP50 Sill Stop. (DP50 Sill Stop is applied on top of pre-finished Sill Stop or on top of Stool) If window is not equipped with a DP50 Sill Stop proceed to **step 3**.

Remove screws from DP50 Sill Stop and save for reuse.

Remove DP50 Sill Stop by carefully pulling upwards to release it from sealant and save for reuse. (It may be necessary to cut along DP50 Sill Stop with a utility knife to assist in its removal).

Clean any excess sealant from areas.

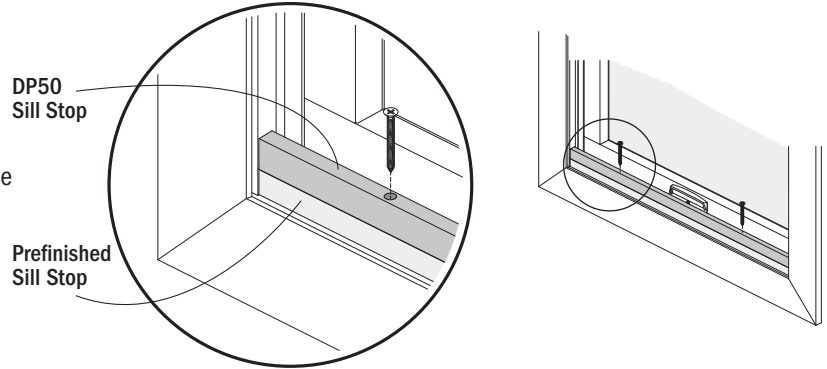

DP50 Sill Stop over Stool

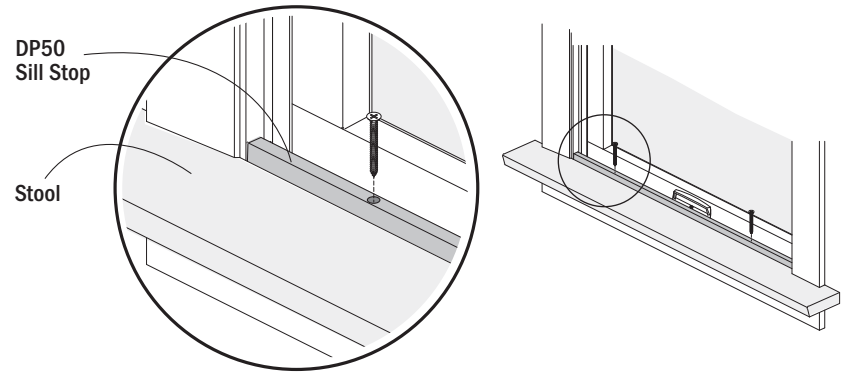

2

Lower top sash completely and remove the two (2) screws located on the top of the Lower Left Jamb Liner (as viewed from the interior).

Raise both sash completely and remove all screws located on the bottom of the Lower Left Jamb Liner.

Place left hand across top of Lower Left Jamb Liner and hold in place. Use right hand to bend and pull outward on bottom of Lower Left Jamb Liner to remove.

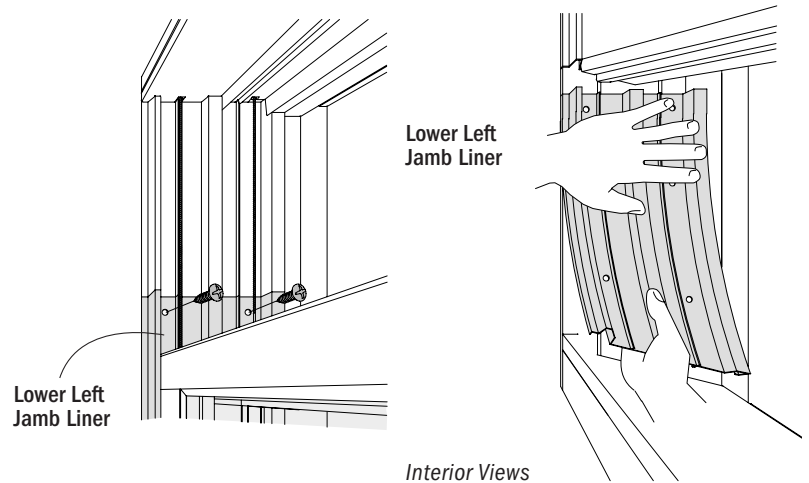

3

Close Bottom Sash completely. Pull out left side and hold sash in position.

CAUTION

Sash cords are under high tension. Use caution when unhooking sash cord from sash. Sash cord could snap back up resulting in product damage and/or personal injury.

Pull down on left Sash Cord (as viewed from the interior) with one hand and hold firmly while pulling Sash Cord Tab out of sash with the other.

Ease Sash Cord up into head jamb.

Repeat procedure with right Sash Cord and remove Bottom Sash.

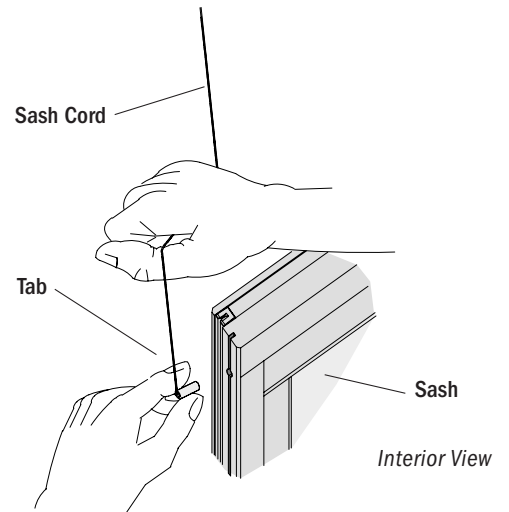
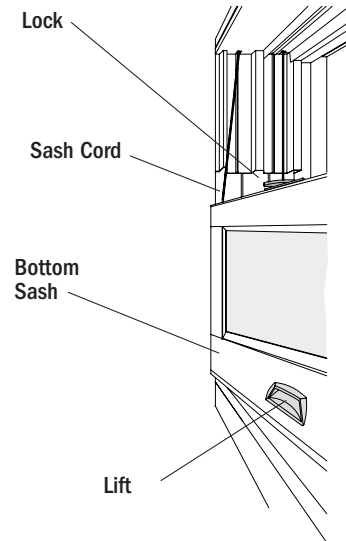

4

Lower Top Sash completely. Pull out left side of sash and hold in position.

CAUTION

Sash cords are under high tension. Use caution when unhooking sash cord from sash. Sash cord could snap back up resulting in product damage and/or personal injury.

Pull down on left Sash Cord (as viewed from the interior) with one hand and hold firmly while pulling Sash Cord Tab out of sash with the other.

Ease Sash Cord up into head jamb.

Repeat procedure with right sash cord.

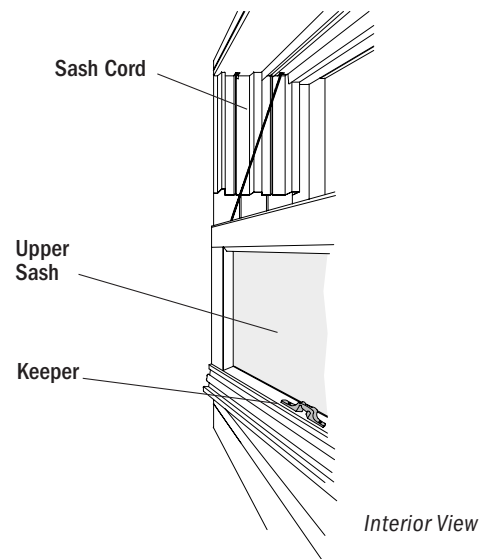

**Primed Narroline® Double-Hung and
200 Series Perma-Shield Narroline® Double-Hung Sash Removal and Reinstallation (continued)**

5 Follow sash removal instructions in reverse to reinstall sash.

6

Units with DP50 Sill Stop

Apply 1/8" bead of Dow Corning 891 sealant to the underside of DP50 Sill Stop (full length in groove and at both ends).

Reapply DP50 Sill Stop to pre-finished sill stop or stool, and fasten through same holes reusing screws.

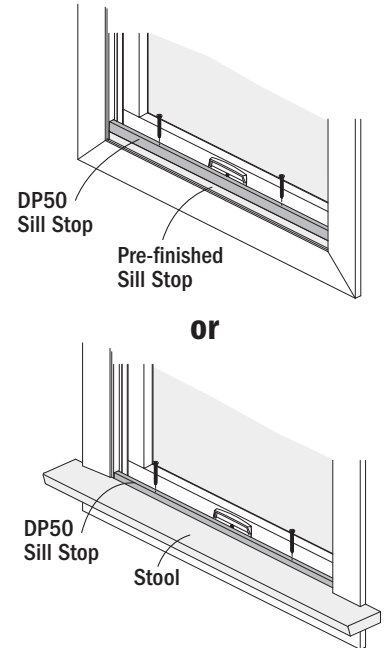
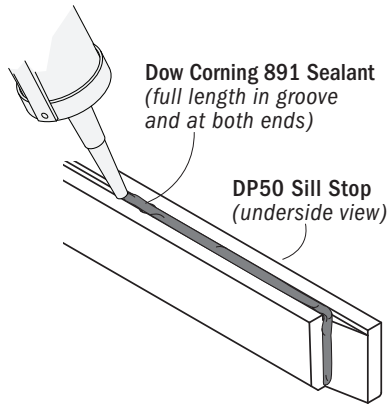

► Primed Narroline® Double-Hung and 200 Series Perma-Shield Narroline® Double-Hung Sash Removal and Reinstallation is complete